

RCA Visualisation Lab Manager (Specialist Technical Instructor in Visualisation & Simulation) April 2024

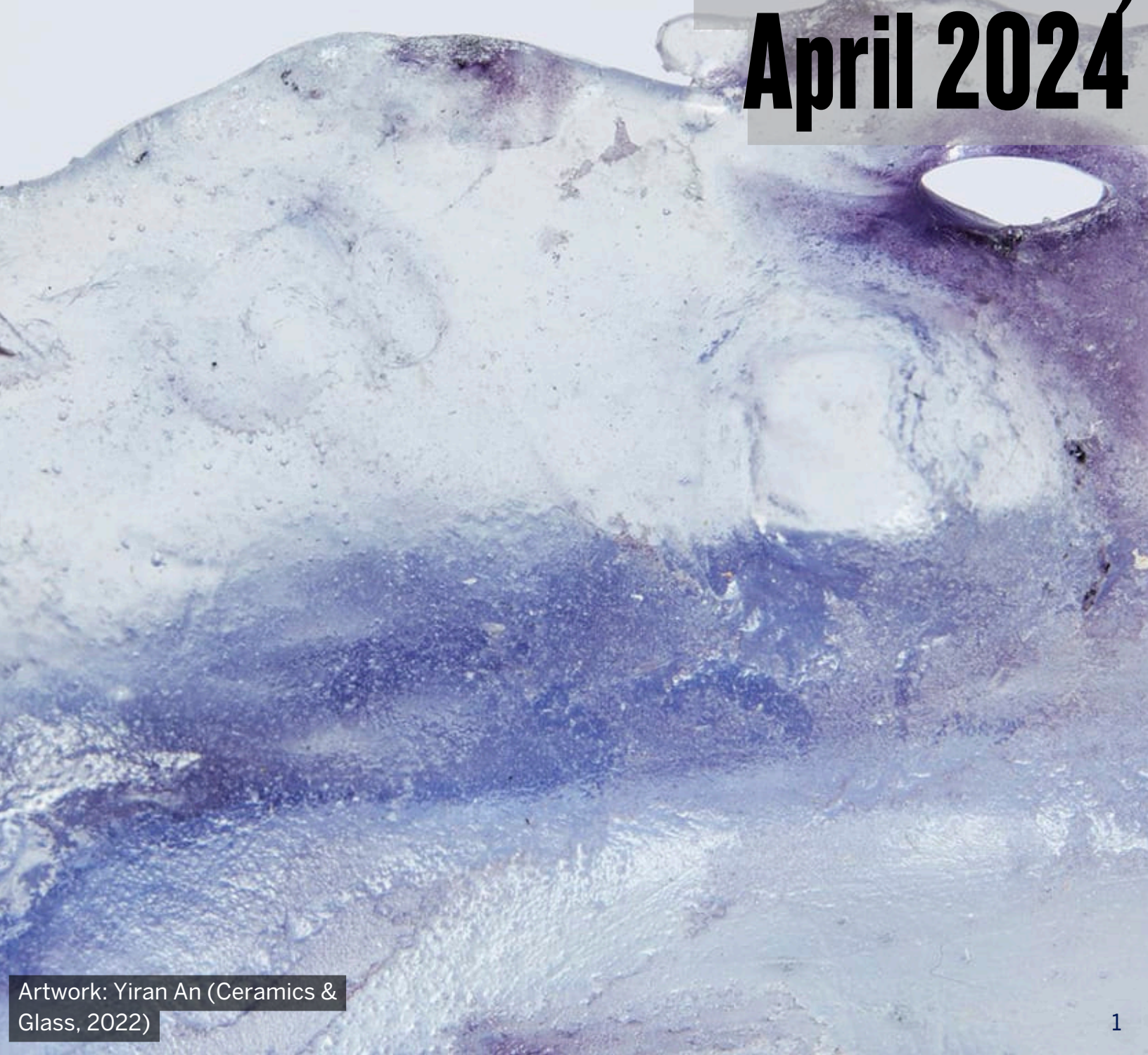

CONTENTS



Photo: Richard Haughton

3	<u>About RCA</u>
4	<u>Our Strategy</u>
5	<u>Our People</u>
6	<u>Our Values</u>
7	<u>About the Role</u>
11	<u>Person Specification</u>
12	<u>Pay and Benefits</u>

WELCOME TO THE RCA

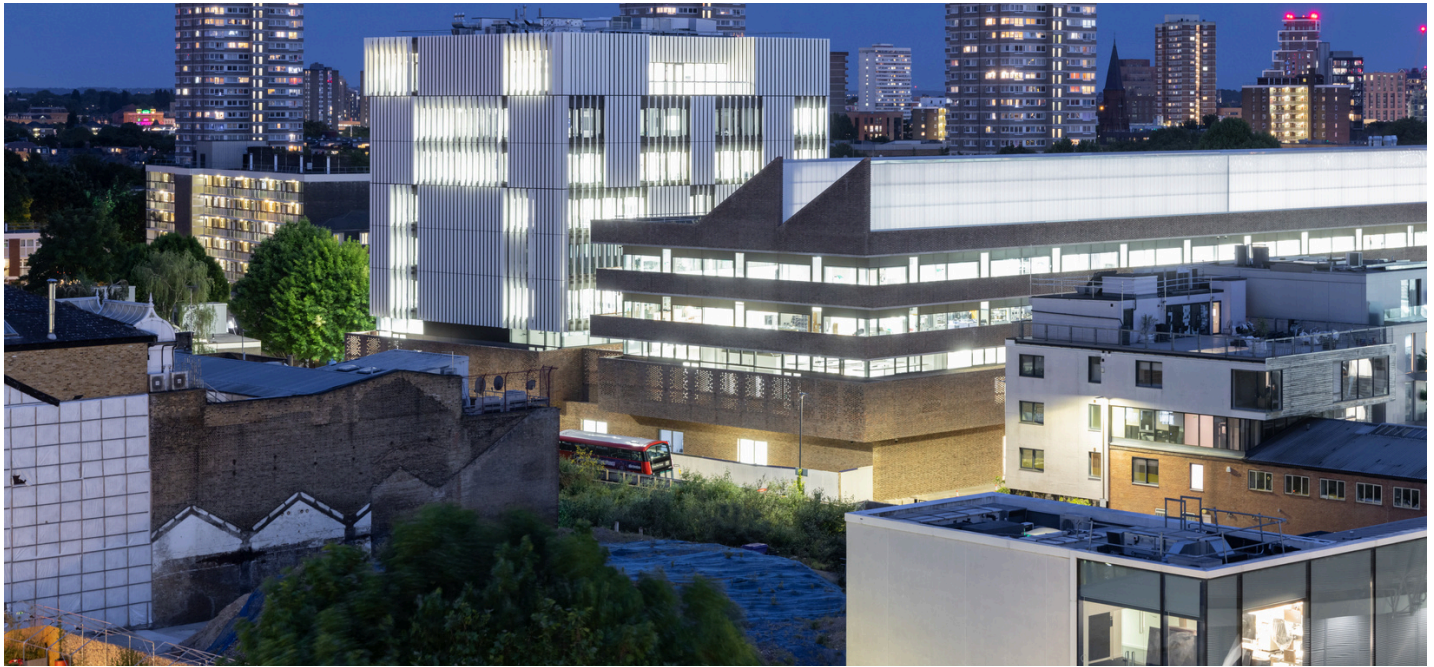

Photo: Iwan Baan

Founded in 1837, the Royal College of Art is the world's largest community of postgraduate art and design students. It is also the oldest art and design university-level institution in continuous operation and has been ranked as the world's number one art and design university for a remarkable ten consecutive years, according to the QS World University Rankings by Subject 2024 – the worldwide survey of academic and industry opinion.

The RCA is research-led and recognised in the UK-wide REF (Research Excellence Framework) as the UK's most research-intensive institution – with an increased proportion of the College's outputs classed as 'internationally excellent' and 'world-leading' in the most recent REF assessment of 2021.

Studying at the RCA is the starting point for the world's creative leaders. With more than 25,000 RCA alumni across the globe, the RCA's graduates form a unique international network of artists, designers, creators and innovators. Every year, RCA alumni are recognised as leaders in their discipline, making national and international headlines for their work, which shapes the world we live in. Its graduate start-up incubator, InnovationRCA, is one of the most successful in the country with a high proportion of female start-up founders and a high 'survival' percentage after five years of trading.

More than 2,800 students are spread across four schools and research and academic departments, studying at Graduate Diploma, MA, MFA, MDes, MArch, MEd, MRes, MPhil and PhD levels. The College's mix of professionalism and creative freedom, together with its renowned academic community and rigorous academic framework provides the ecosystem in which students flourish and achieve their highest potential.



Photo: Richard Haughton

In addition, the RCA has a number of established and planned research centres: the Helen Hamlyn Centre for Design; the Material Science Research Centre (which includes the Materials Futures Research Group and the Textiles Circularity Centre); the Intelligent Mobility Design Centre, Computer Science Research Centre, and a future centre in Drawing. The RCA is also home to one of the UK's most successful university incubators, InnovationRCA.

The RCA espouses a hybrid approach, supporting 'traditional' making and technical skills in fine and applied art and design alongside the foundational sciences, engineering and technology which underpin designers' ability to solve today's global challenges. The RCA champions the value of interdisciplinary learning and was the first art and design university in the world to implement a STEAM (Science, Technology, Engineering, Art and Design and Mathematics) academic vision, with investment in new faculty posts in Materials Science; Computer Science and Robotics alongside art and design disciplines. By applying creative insights to evidence-based science, its staff, students, researchers and start-ups are addressing major global challenges such as rapid urbanisation and transport; loss of biodiversity; ageing populations; unsustainable consumption and production; and the rise of AI.

Our Strategy

The RCA's strategic vision is to increase its influence on the world stage of globally ranked universities, punching significantly above its weight, and attracting, supporting and convening the world's most talented faculty, students, artists, designers and creative leaders. For more information on The RCA's Strategic Plan 2022–27, please click on this link: [Strategic Plan 2022–27](#).

Our People



Photo: Richard Haughton

The RCA's Chancellor is Sir Jony Ive, and the Pro-Chancellor and Chair of Council is Sir Peter Bazalgette (please see link to Council independent members' biographies). The RCA's President and Vice-Chancellor – the CEO of the institution – is Dr Paul Thompson, who joined the College in 2009, but will be leaving in May 2024. The incoming President and Vice-Chancellor is Professor Christoph Lindner, who joined the RCA in April 2024.

The RCA's academic faculty bring world-leading expertise and industry knowledge to the practice-based model of teaching. There is a core academic and research workforce of 196 FTE, supported by around 215 Associate Lecturers and a wide range of Guest Lecturers who bring 'live' industry experience into the taught curriculum – for example, Amin Taha of GrantOn design, whose work was twice shortlisted for the RIBA Stirling Prize, in 2017 and 2021, teaches in the School of Architecture; and Yao Yingjia, who is Vice President and Chief Designer at Lenovo teaches in the School of Design.

The RCA combines contemporary and industry-focused teaching perspectives. It also employs a team of 95 highly skilled technicians, many of whom themselves have postgraduate qualifications in their fields of specialism, which range from rapid prototyping and subtractive manufacturing to film and sound engineering, and from digital modelling to metal fabrication and jewellery making.

Our Values



Photo: Shaun James

The RCA community operates in line with four agreed values:



Curiosity

We have a tenacious commitment to innovation and openness to change. We positively interrogate ideas, assumptions and plans and welcome the honest scrutiny that is alive in a learning community.



Inclusion

We celebrate diversity and embrace difference as a source of strength. We strive for an inclusive RCA community, removing barriers and challenging exclusionary and discriminatory practices.



Collaboration

We value what happens together and we help and support each other to achieve our collective goals. We work in partnership with our students, staff, alumni, institutions and communities across the globe to make a lasting difference.



Integrity

We are always willing to listen, we offer constructive feedback and we promote accountability, building relationships of mutual trust and respect. We are resilient in the face of challenges, pursuing outcomes with individual, cultural, societal and economic impact.

ILTS (Information, Learning & Technical Services)



Photo: Richard Haughton

ILTS (Information, Learning, and Technical Services) is a cross-College directorate that supports staff and students to meet their academic objectives through a broad range of services. We provide leadership and expertise in implementing digital systems to enable more efficient working practices across the College. We have skilled and specialist staff on all three RCA sites.

Technical Services is one of the service divisions of Information, Learning and Technical Services (ILTS), a cross college department, which includes the Library, Archives and Collections, IT and Audio-Visual Services.

The College has built a new Rausing Research and Innovation building at Battersea South which houses a range of experimentation and workshop facilities, which includes a multimodal SNAP Visualisation Lab. Offering double height, three sided stereoscopic capable projection, a spatial tracking array and high quality sound, the space will allow for large scale visuals, virtual environments, and data analytics. Comprising audio, projection, and tracking hardware and software for multimedia playback and 3D Model and CAD conversion, the space will support staff to engage with partners and develop their research.

Visualisation Lab Manager (Specialist Technical Instructor in Visualisation & Simulation)



Photo: Richard Houghton

Purpose of the post:

- Take a lead in ensuring the effective provision and availability of specialist equipment and work areas in order to facilitate academic delivery, research and knowledge exchange activities.
- Provide highly skilled technical assistance, guidance and technical instruction to all users, demonstrating equipment and processes as appropriate.
- Work with a variety of users to provide day-to-day support for the functioning of the Visualisation Laboratory (Vis Lab).

Main Duties and Responsibilities:

Plan, organise and deliver technical support, advice and demonstrations in the SNAP Visualisation Lab, including technical support for research and knowledge exchange projects with staff and partners.

Take a lead in ensuring the effective provision and availability of specialist equipment and work areas in order to facilitate research and knowledge exchange activities.

Actively support the growth of the Visualisation Lab technical spaces, equipment and resources across the College.

Be responsible for managing and organising the lab space. Operate and maintain the equipment, which includes projectors, a spatial tracking array, an audio system and computing hardware and software.

To develop project briefs, scope and resource requirements jointly with research teams and external partners.

Organise and maintain specialist equipment in the lab and keep accurate records. Undertake requisitions and ordering as required. Support the research through identification and development of industry links and identifying new and relevant technologies and practices.

Monitor work being carried out in the lab, ensuring high standards of safety and housekeeping and maintaining a safe working environment in accordance with H&S policies and procedures. Oversee and monitor lab usage and occupancy.



Photo: Iwan Baan

Main Duties and Responsibilities (cont):

Promote best practice within the visualisation technical spaces, maintain specialist equipment, monitor safety and keep accurate records. Actively support the Technical Coordinator in the completion of risk assessments, ensuring all assessments are suitable, sufficient and remain up to date.

Ongoing learning of visualisation and simulation technologies and opportunities as part of a dynamic team.

Assist users of all abilities in problem solving and finding technical solutions for research.

Support college Teaching, Learning & Research activity that may require support in the development of visualisation as appropriate for the role.

Participate in the reviewing and monitoring of technical facilities. Liaise with Academic, Technical and Research staff and all other users with regards to the current resource provision and future developments.

Develop and create learning and promotional material, which may include guidance materials for lab usage.

Write clear and concise technical documentation and operations manuals for the areas equipment and software.

Represent technical services and the Research & Innovation Directorate by attending appropriate meetings as agreed with the Technical Coordinator.

Comply with all Royal College of Art policies and procedures.

Assist in the selection, training, induction and supervision of new and/or temporary staff.

Undertake any other duties consistent with the role as required and in agreement with the Academic Lead or Technical Coordinator.



Photo: Philip Vale

Person Specification

Essential

- Significant knowledge and experience of managing multi-user spaces, including equipment management, software updates, and user configuration.
- Experience of delivering virtual environment projects in a game development platform (such as Unreal, Unity, etc.)
- An understanding of at least one CAD or 3D modelling software (such as Blender, Rhino)
- Experience in processes and techniques related to large scale visualisation.
- Excellent communication and interpersonal skills, both written and verbal
- Excellent organisational and planning skills with the ability to prioritise and manage time across priorities as appropriate
- Excellent problem solving skills, user focus and a flexible approach
- Commitment to continuing professional development and engagement with professional issues
- Ability to share knowledge and transfer skills and capabilities

Desirable

- Experience of audio production software, audio recording, processing and mixing techniques.
- Experience of managing audio systems as part of a visualisation or simulation experience
- Experience with the lab software suite: Techviz, VIOSO Vertex, Skyreal



Pay & Benefits

Additional Information:

- Grade 7 salary working 35 hours per week: £42,205 to £45,732 per annum inclusive of London Allowance.
- 25 days annual leave plus extended breaks at Christmas and Easter at the discretion of the college. 27 days per annum from next holiday year, starting October 2024.
- Contributory final salary pension scheme and interest free season ticket loan are available.
- Based in London - Battersea
- Responsible to: Technical Coordinator
- 1 FTE, 2 year fixed term role



Photo: Philip Vale

Pension

The Royal College of Art is a member of the Superannuation Arrangements of the University of London (SAUL) which is a contributory defined benefit pension scheme. The college will contribute a sum equal to 16% of your salary while you pay 6%.

Holiday

25 days paid leave a year plus bank and public holidays normally observed in England and Wales. In addition, the college is normally closed for six days a year, one day on either side of Easter and the remainder between Christmas and New Year. Part-time staff will be entitled to the pro rata equivalent. Moving to 27 days per annum next holiday year.

Season ticket loans

Interest-free loans are available for staff to purchase annual season tickets.

Enhanced maternity and adoption pay

Qualifying employees are entitled to enhanced maternity/adoption pay: 26 weeks' full pay, 13 weeks Statutory Maternity/Adoption Pay. This compares to the statutory provision of 90% of average pay for 6 weeks followed by Statutory Maternity/Adoption Pay for 33 weeks.

Enhanced paternity pay

Qualifying employees are entitled to two weeks' paternity leave entitlement at full pay. This compares to the statutory provision of two weeks' pay at the statutory rate.

Enhanced shared parental pay

Qualifying employees are entitled to enhanced shared parental pay: up to 24 weeks' paid at the full rate of the employee's normal pay (only in the first 26 weeks following the start of maternity/adoption leave), followed by 13 weeks Statutory Shared Parental Pay. This compares to the statutory provision of up to 37 weeks paid at the statutory rate or 90% of average weekly earnings, whichever is lower.

Enhanced sick pay

Occupational sick pay after three months' service is three months full pay/three months half pay.

24/7 confidential support

Staff and family members in their household have access to a free, external confidential support service for work, financial, legal, family and personal problems 24 hours a day, 365 days a year.

Occupational health

Occupational Health support for the College is provided by Imperial College's occupational health service at their South Kensington Campus.

Life Cover

Active members of the SAUL pension scheme automatically receive life cover. A lump sum of four times your salary together with a refund of your contributions and a 2/3 pension for your dependent/spouse is payable should you die whilst in employment.

Library

All staff are welcome to join the college library.

Events

All staff are welcome to attend exhibitions, lectures and private views held by academic schools and programmes.



10 YEARS

as the world's N°1
University for Art & Design

QS World University Rankings by Subject 2015-24